

PVC-U - COMPACT VALVES

MATERIALS

Lever: PP / PVC-U
Sphere backups: TEFLON
O'ring gaskets: E.P.D.M.
Body and remaining components: PVC-U

STANDARDS

The jointing valves strictly respect the standards EN 1452-2.
The screwing valves strictly respect the standards EN10226-1 and ISO 7/1.

ASSEMBLY

The jointing valves: by jointing always using appropriate glues.
The screwing valves: by screwing according to ISO 7/1 recommendations.

SERVICE PRESSURE

The service pressure, just as an indication, is of 10 bar at 20° (water) for the valves up to 63-2" and 6 bar at 20°C (water) for the valves of 75-2"½ and 90-3".

ABBREVIATION INTERPRETATION

d	- Nominal diameter
G	- Nominal diameter of the screw
Quant	- Quantity of fittings that each box contains
Gr	- Approximate weight of fittings in grams
B	- Box 29 x 23 x 16.5
C	- Box 39 x 29 x 31

PVC-U - COMPACT VALVES

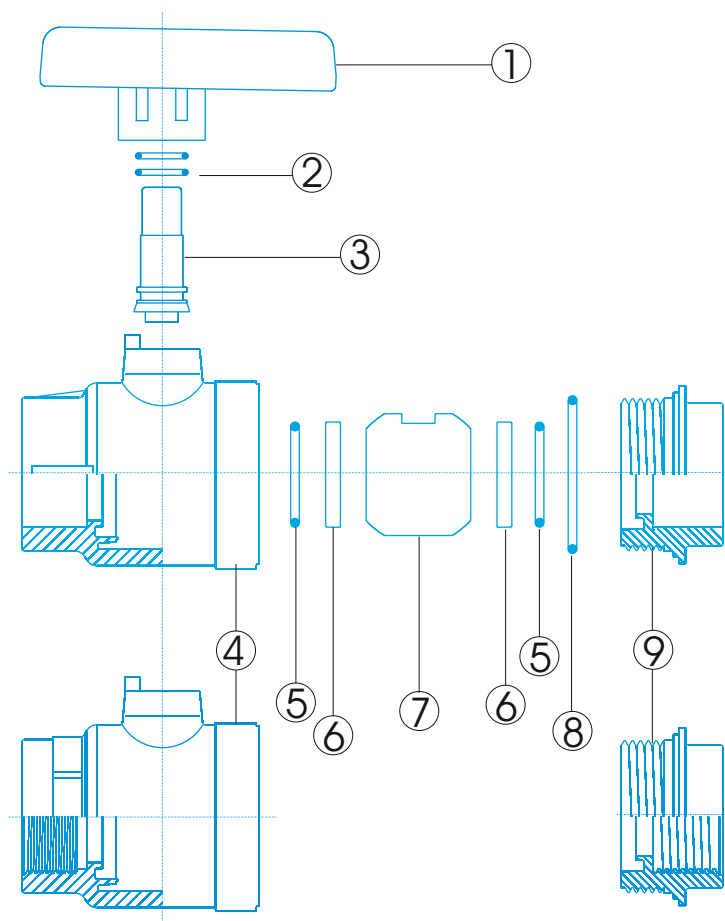

Nº REF.	COMPONENT	MATERIAL	QUANT.	Nº REF.	COMPONENT	MATERIAL	QUANT.
1	lever	pp pvc-u	1	6	apoio da esfera	ptfe	2
2	o'ring	epdm	2	7	ball	pvc-u	1
3	stem	pvc-u	1	8	o'ring	epdm	1
4	body	pvc-u	1	9	thread cap	pvc-u	1
5	o'ring	epdm	2				